



clean-tek®

Reinraumtechnik GmbH+Co. KG

Steinbeisstraße 4

71272 Renningen

Telefon +49 (0) 71 59 / 93 12-0

Telefax +49 (0) 71 59 / 16 12 51

www.clean-tek.de

info@clean-tek.de

Wall protection system

The **clean-tek** wall protection system consists of ramming protection on the wall and also at floor level. Within the production and packaging areas it effectively protects those surfaces against scratches and other types of damage.

For **optimum protection** the two parts can be combined with a support framework that is attached to both wall and floor. This carries a 2 mm thick stainless steel cover to **GMP** standards.

All collision forces are then absorbed as deformation energy by the stainless steel cover and where necessary the support framework.

The wall protection can be attached **to any wall**, be it metal, dry studding or masonry construction.

The modular design permits easy and quick replacement of the elements in the event of a serious impact or if modification is required. Because the ramming protection is attached to the floor, the use of mechanical **floor cleaning** machines creates **no problems**.



Ramming protection in the production area



Combination of ramming protection at floor and wall levels



Combination of ramming protection at floor and wall levels as a custom-built installation



Technical data

Wall protection

Material Stainless steel

Height 220 mm

Projection 30 mm

Length Up to 2500 mm

Optional accessories

Internal corner 90°

External corner 90°

End pieces

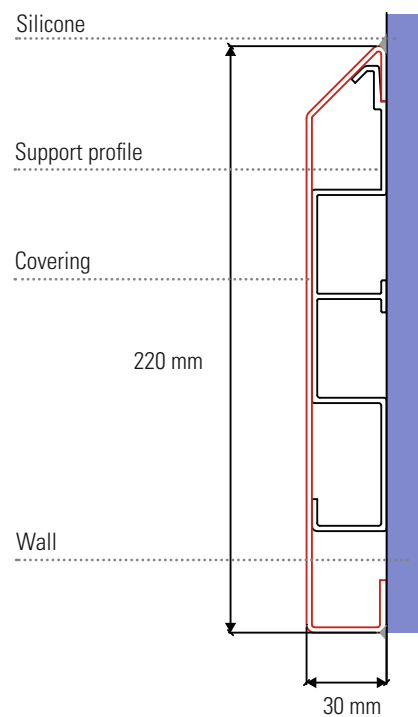

Structure of wall protection

Ramming protection

Material Stainless steel

Height 195 mm

Projection 67,5 mm

Length Up to 2500 mm

Optional accessories

Internal corner 90°

External corner 90°

End pieces

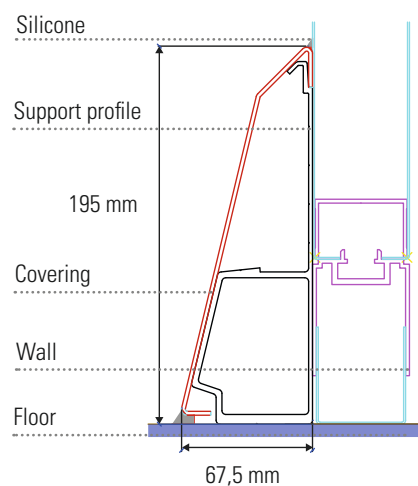

Structure of ramming protection